

# Globe Valve

Bolted Bonnet, Rising stem, Flanged  
Carbon, Alloy and Stainless Steel



SIZE	CLASS	MODEL NO.
DN 40-300 (1 1/2"-12")	150	GB-1-S-F-A1
DN 40-300 (1 1/2"- 12")	300	GB-1-S-F-A2
DN 50-200 (2" - 8")	600	GB-1-S-F-A3



### Features

- Suitable for throttling as well as shutoff.
- The Stem nut design allows for the removal of the hand-wheel while keeping the Stem and plug in fixed position.
- All The valves provided with backseat arrangement.
- Two Piece gland functions as the back seat for assured stem sealing at all pressures. It also helps user to replace on-line stem seals.

### STANDARDS COMPLIANCE

- Valve Design BS1873, ASME B 16.34
- End to End ASME B16.10 & ISO 5752
- Flanged Dimensions ASME B16.5 & ISO 7005-1 Part. 1
- Butt weld Dimensions ASME B16.25
- Visual Inspection MSS SP- 55
- Marking MSS SP-25 & ISO 5209

### TESTS AND CERTIFICATES

- Pressure testing API 598 & BS EN 12266-1
- Other ISO 9001:2008

No.	DESCRIPTION	MATERIAL					
		ASTM SPECIFICATION					
1	BODY	A 216 WCB	A 352 LCB	A 351 CF8	A 351 CF3	A 351 CF8M	A 351 CF3M
2	SEAT RING	A276-410 OR WITH STL.		304/304 STL.	304 L/304L STL.	316/316 STL.	316 L /316 L STL.
3	PLUG	A276-420 OR WITH STL.		304/304 STL.	304 L/304L STL.	316/316 STL.	316 L /316 L STL.
4	STEM NUT	CARBON STEEL		STAINLESS STEEL			
5	STEM	A276 410		A 276 304	A 276 304 L	A 276 316	A 276 316 L
6	BONNET BUSH	A276 410		A 276 304	A 276 304 L	A 276 316	A 276 316 L
7	BONNET	A 216 WCB	A 352 LCB	A 351 CF8	A 351 CF3	A 351 CF8M	A 351 CF3M
8	GLAND PACKING	GRAPHITE		GRAPHITE/PTFE			
9	GLAND BUSH	A276 410		A 276 304	A 276 304 L	A 276 316	A 276 316 L
10	GLAND FLANGE	CARBON STEEL		STAINLESS STEEL			
11	CROSS BOLT & NUT	CARBON STEEL		STAINLESS STEEL			
12	EYE BOLT & NUT	A 193 GR.B7/194 2H	A 320 L7M/194 7M	A 193 GR.B7/A194 GR.2H OR B8/8			
13	YOKE SLEEVE	SG IRONNICKEL RESIST					
14	HAND WHEEL	CARBON STEEL / MALLEABLE IRON					
15	WASHER	CARBON STEEL					
16	HAND WHEEL NUT	CARBON STEEL					
17	BODY JOINT STUD & NUT	A 193 GR.B7/194 2H	A 320 L7M/194 7M	A 193 GR.B7/A194 GR.2H OR B8/8			
18	BODY JOINT GASKET	SS 304 SPW + GRAPHITE		SS 316 SPW + GRAPHITE			

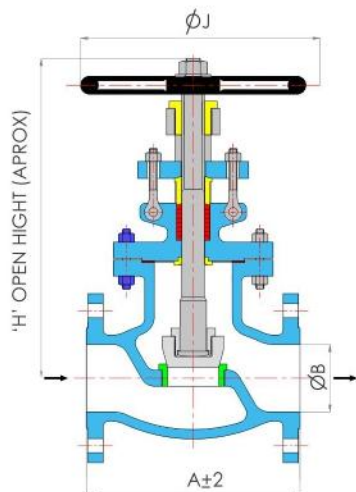
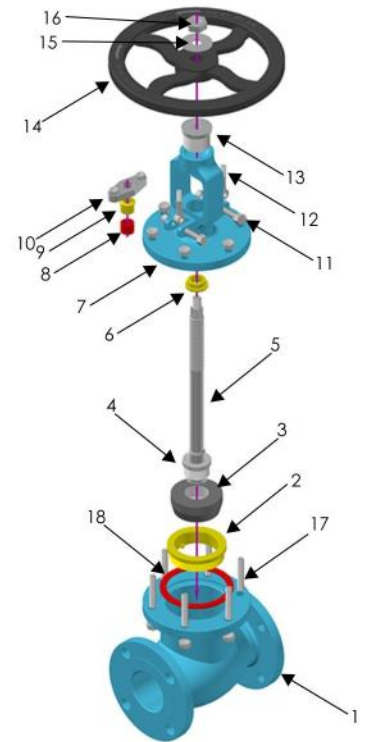

SIZE	B	A	CLASS 150			CLASS 300			CLASS 600		
			H	J		A	H	J	A	H	J
40	38	165	251	152	229	305	152				
50	51	203	308	203	267	405	200	292	480	250	
65	63	216	378	203	292	470	250	330	530	250	
80	76	241	405	254	318	505	250	356	630	300	
100	102	292	475	305	356	615	300	432	750	350	
125	125	356	516	305							
150	152	406	556	356	445	865	350	559	975	150	
200	203	495	663	450	559	1092	450	660	1230	500	
250	254	622	855	500	622	1300	500				
300	306	699	905	500	711	1400	550				

ALL DIMENSIONS ARE IN MM