

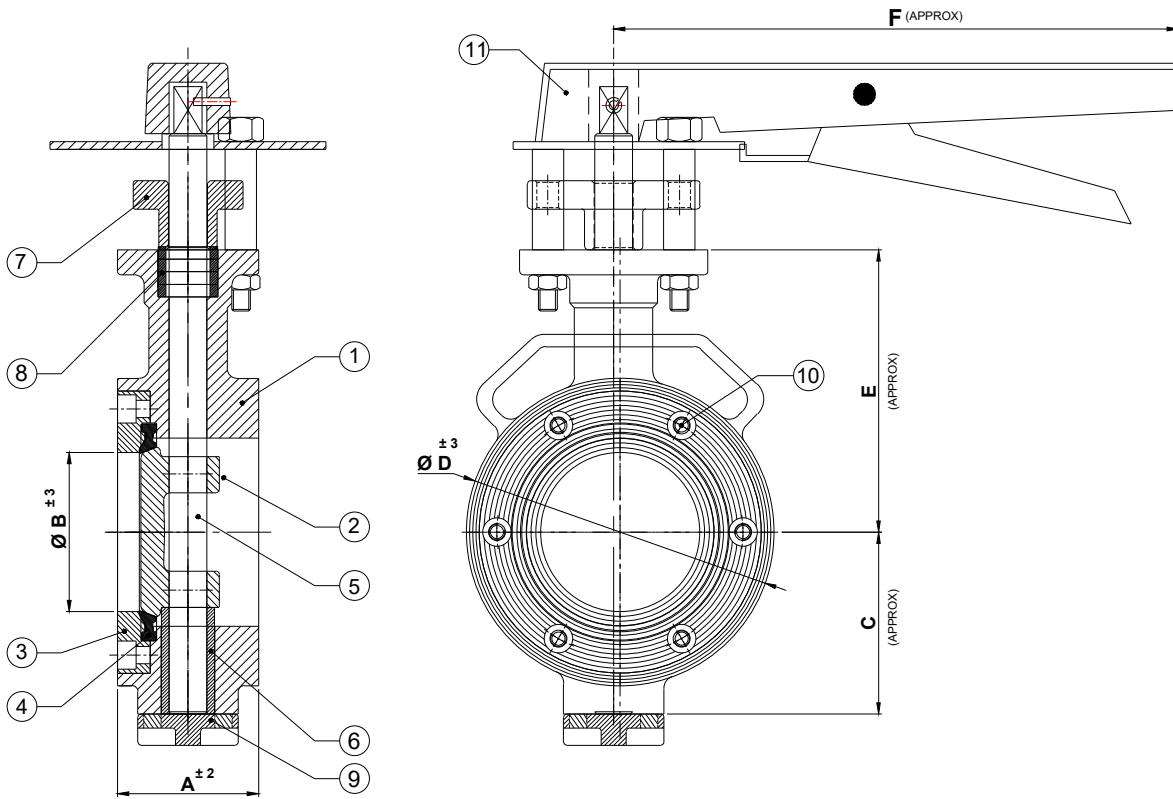

Mevada Engineering Works Pvt. Ltd.

Unit No.1, Plot No.9, Mistry Industrial Estate, I.B.Patel Road,
Goregaon (East), Mumbai - 400063. INDIA
Email: sales@saturnvalves.com
Visit: www.saturnvalves.com

DRN ABDUL	DATE 21/04/2018	
WAFER TYPE BUTTER FLY VALVE.		
DRG. NO :	WSDV/40 - 200	



Double Eccentric Disc Design

Valve Size	A	ØB	C	ØD	E	F
1½" (40mm)	42	40	51	85	85	180
2" (50mm)	45	51	58	98	90	180
2½" (65mm)	48	61	63	115	102	180
3" (80mm)	48	72	70	131	120	215
4" (100mm)	54	100	86	159	134	215
5" (125mm)	57	123	105	188	154	265
6" (150mm)	57	143	120	219	170	265
8" (200mm)	63	192	145	272	200	325

No.	Description	Material
11	Lever	M.S.
10	L.N. Bolt	S.S. 202 / S.S. 304
9	Bottom Cover	WCB/CF8
8	Gland Packing	PTFE
7	Gland	WCB/CF8
6	Shaft Bearing Bush	AISI 410/304/316
5	Shaft	AISI 410/304/316
4	Seat Ring	PTFE / GFT / VITON
3	Retainer	WCB/CF8/CF8M
2	Disc	CF8/CF8M
1	Body	WCB/CF8/CF8M

TESTING

PRESSURE RATING	HYDROSTATIC SHELL TEST		HYDROSTATIC SEAT TEST	
	Kg/CM2	PSI	Kg/CM2	PSI
PN10	15	210	10	140

CONFORMITY TO CODES & STANDARDS

- 1) DESIGN & MANUFACTURE :- API 609
- 2) VALVE FACE TO FACE DIMENSION :- BS 5155 / API 609 Category B
- 3) TOP FLANGE DRILLING :- ISO 5211
- 4) VALVE INSPECTION & TESTING :- BS 6755 Part - I / API 598 / EN 12266-1
- 5) FLANGE STANDARD CONFORMITY :- ANSI 150 / IS 6392 NP 1.0 / 1.6



Mevada Engineering Works Pvt. Ltd.

Unit No.1, Plot No.9, Mistry Industrial Estate, I.B.Patel Road,
Goregaon (East), Mumbai - 400063. INDIA
Email: sales@saturnvalves.com
Visit: www.saturnvalves.com

DRN
ABDUL

DATE
21/04/2018

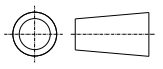

WAFER TYPE BUTTER FLY VALVE.

DRG. NO : WSDV/40 - 300

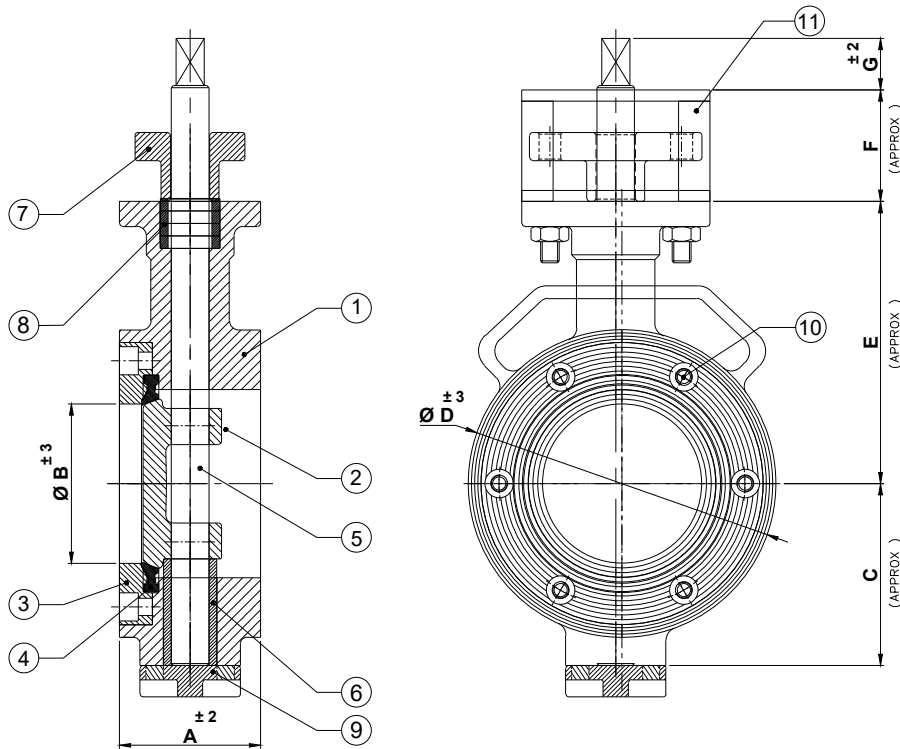

Double Eccentric Disc Design

Valve Size	A	ØB	C	ØD	E	F	G	Squaer	BRACKET PCD
1½" (40mm)	42	40	51	85	85	35	18	9X9	50
2" (50mm)	45	51	58	98	90	35	18	9X9	50
2½" (65mm)	48	61	63	115	102	40	18	11X11	50
3" (80mm)	48	72	70	131	120	40	18	11X11	50
4" (100mm)	54	100	86	159	134	40	18	11X11	50
5" (125mm)	57	123	105	188	154	40	18	14X14	70
6" (150mm)	57	143	120	219	170	40	18	14X14	70
8" (200mm)	63	192	145	272	200	40	22	17X17	70
10" (250mm)	72	240	175	325	230	63	30	27X27	102
12" (300mm)	83	290	215	385	270	63	35	27X27	102

11	Bracket	WCB / CF8
10	L.N. Bolt	S.S. 202 / S.S. 304
9	Bottom Stem Cover	WCB / CF8
8	Gland Packing	PTFE
7	Gland	WCB / CF8
6	Shaft Bearing Bush	AISI 410/304/316
5	Shaft	AISI 410/304/316
4	Seat Ring	PTFE / GFT / CFT
3	Retainer	WCB / CF8 / CF8M
2	Disc	CF8 / CF8M
1	Body	WCB / CF8 / CF8M
No.	Description	Material

TESTING

PRESSURE RATING	HYDROSTATIC SHELL TEST		HYDROSTATIC SEAT TEST	
	Kg/CM2	PSI	Kg/CM2	PSI
PN10	15	210	10	140

CONFORMITY TO CODES & STANDARDS

- 1) DESIGN & MANUFACTURE :- API 609
- 2) VALVE FACE TO FACE DIMENSION :- BS 5155 / API 609 Category B
- 3) TOP FLANGE DRILLING :- ISO 5211
- 4) VALVE INSPECTION & TESTING :- BS 6755 Part - I / API 598 / EN 12266-1
- 5) FLANGE STANDARD CONFORMITY :- ANSI 150 / IS 6392 NP 1.0 / 1.6



Mevada Engineering Works Pvt. Ltd.

Unit No.1, Plot No.9, Mistry Industrial Estate, I.B.Patel Road,
Goregaon (East), Mumbai - 400063. INDIA
Email: sales@saturnvalves.com
Visit: www.saturnvalves.com

DRN
ABDUL

DATE
21/04/2018

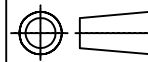

WAFER TYPE BUTTER FLY VALVE.

DRG. NO : WSDV/150 - 500

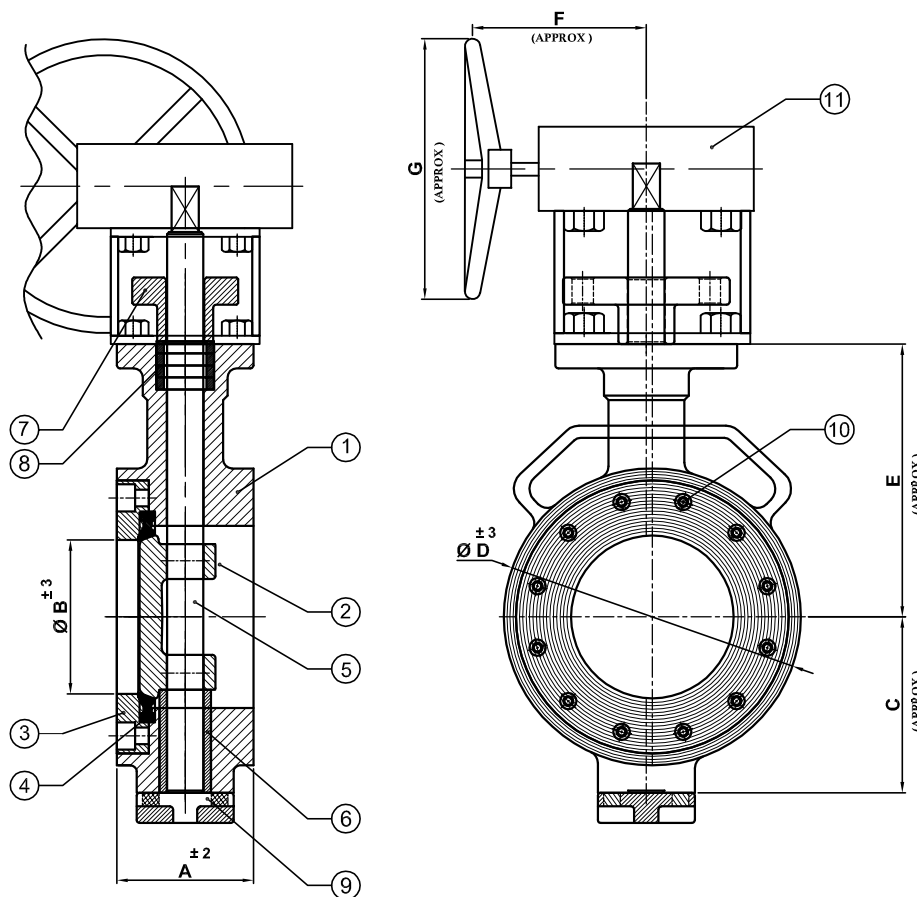

Double Eccentric Disc Design

Valve Size	A	ØB	C	ØD	E	F	G	FLANGE MOUNTING (I.S.O 5211)
6" (150mm)	57	143	120	219	170	240	200	F 07
8" (200mm)	63	192	145	272	200	285	250	F 07
10" (250mm)	72	240	175	325	230	285	250	F 10
12" (300mm)	83	290	215	385	270	300	350	F 10
14" (350mm)	92	335	240	435	320	300	350	F 12
16" (400mm)	102	360	280	495	365	305	450	F 12
18" (450mm)	114	400	305	538	375	305	450	F 14
20" (500mm)	127	465	340	590	410	370	450	F 16

11	Gear Box	Cast Iron
10	L.N. Bolt	S.S. 202 / S.S. 304
9	Bottom Cover	WCB / CF8
8	Gland Packing	PTFE
7	Gland	WCB / CF8
6	Shaft Bearing Bush	AISI 410/304/316
5	Shaft	AISI 410/304/316
4	Seat Ring	PTFE / GFT / CFT
3	Retainer	WCB / CF8 / CF8M
2	Disc	CF8 / CF8M
1	Body	WCB / CF8 / CF8M
No.	Description	Material

TESTING

PRESSURE RATING	HYDROSTATIC SHELL TEST		HYDROSTATIC SEAT TEST	
	Kg/CM2	PSI	Kg/CM2	PSI
PN10	15	210	10	140

CONFORMITY TO CODES & STANDARDS

- 1) DESIGN & MANUFACTURE :- API 609
- 2) VALVE FACE TO FACE DIMENSION :- BS 5155 / API 609 Category B
- 3) TOP FLANGE DRILLING :- ISO 5211
- 4) VALVE INSPECTION & TESTING :- BS 6755 Part - I / API 598 / EN 12266-1
- 5) FLANGE STANDARD CONFORMITY :- ANSI 150 / IS 6392 NP 1.0 / 1.6